

Project: _____
 Location: _____
 Cat. #: _____
 Type: _____
 Quantity: _____

Powered by  Biotechnology

ADB 7000-T | Air Disinfection Biosecurity Unit

Features:

- 24/7 365 continuous and proactive air and surface disinfection
- Quiet operation
- Low power consumption
- No toxic chemicals or irradiation
- Provides a comprehensive disinfection solution for use in public spaces to achieve a new air quality safety threshold by neutralizing up to 99.99% of viruses (influenza, norovirus, etc.) within minutes and bacteria (listeria, salmonella, E. coli, campylobacter, etc.) within 2 hours
- Used for over 20 years and is installed in thousands of locations, worldwide

Applications:

- Suitable for common area applications - indoor/public spaces
- Government Buildings
 - Hospitality
 - Healthcare
 - Fitness/Locker Rooms
 - Food/Meat Processing
 - K12/Higher Education
 - Offices
 - Meeting Room/Break Rooms
 - Industrial/Commercial
 - Restaurants
 - Retail
 - Casinos
 - Horticulture

Certifications:

- Certified Halal by Islamic Services of America

Details:

- ADB systems activate ambient air using proprietary Modulated Dielectric Barrier Discharge that generates a safe, chemical-free non-thermal (cold) plasma. Highly reactive molecules from the plasma are distributed throughout the space via integrated turbine to neutralize microbes (viruses, bacteria & mold) and VOCs in the air and on surfaces. This sanitizing cold plasma treatment is continuous, controlled, and consistent.
- Each system is process engineered for the space being treated to ensure continuous & proper treatment levels throughout the space
- Integrated turbine draws air into the unit and distributes treatment into the space. Additional equipment may be necessary to evenly distribute treatment throughout the entire space - ie. fans, or piping/ductwork.
- MERV 11 filter helps keep reaction chamber clean and working properly. Filter must be changed every 90 days at minimum
- ADB units can be paired with a WCS wireless controller for additional control and enhanced diagnostics. One WCS can control up to (20) ADB units

Construction:

- Cabinet constructed of powder coated aluminum
- 3" PVC outlet
- 6' Cord with 120V plug
- MERV 11 filter

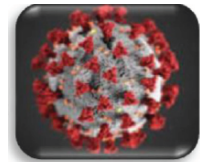
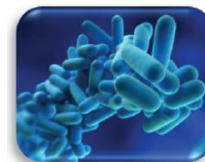

Ordering Guide:

Series	Capacity	Driver	Duty Cycle
ADB 7000			
ADB 7000	1T 1 Power Generator	ID Internal Driver	100 100%
	2T 2 Power Generators		90 90%
	4T 4 Power Generators	ID Internal Driver	80 80%
		ED6C External Driver w/ 6' Cables ⁽¹⁾	70 70%
			60 60%
			40 40%

Notes:

⁽¹⁾ External driver option not available on 1T and 2T models.

Accessories:

WCS Wireless Control System with touch screen interface and networking capabilities. (1) WCS can control up to (20) ADB 7000 units, depending on range

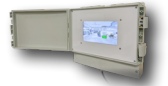

Specifications:

Model	Operation Frequency	Amps	Max Power	Voltage	Weight	Length	Width	Height	Pipe Size
ADB 7000-1T	50/60 Hz	0.28A	33W	120V	21.5 lbs.	20.0"	8.52"	12.71"	3" PVC
ADB 7000-2T	50/60 Hz	0.32A	38W	120V	21.5 lbs.	20.0"	8.52"	12.71"	3" PVC
ADB 7000-4T	50/60 Hz	0.38A	45W	120V	42.4 lbs.	30.0"	8.5"	19.7"	3" PVC

Schematic:

ADB 7000-1T & 2T:

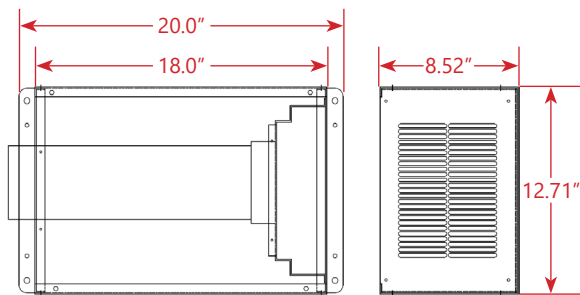

ADB 7000-4T:

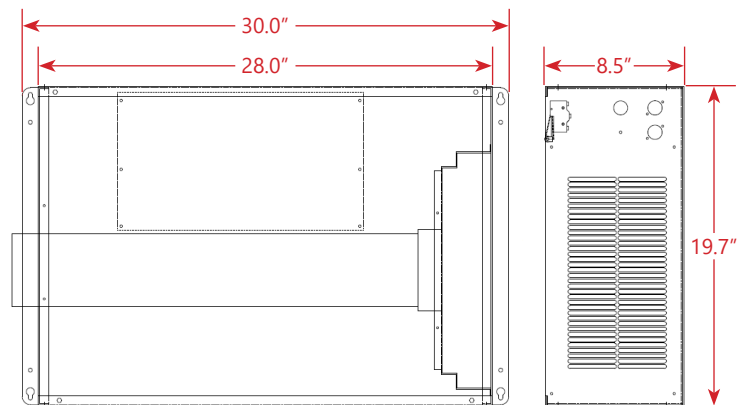

Performance Capacity:

Commercial Applications / Biosecurity:

Model	Duty Cycle	Volume (ft³)
ADB 7000-4T	100%	68,850 to 76,500
	90%	61,200 to 68,850
	80%	53,550 to 61,200
	70%	45,900 to 53,550
	60%	30,600 to 45,900
	40%	22,950 to 30,600
ADB 7000-2T	100%	34,425 to 38,250
	90%	30,600 to 34,425
	80%	26,775 to 30,600
	70%	22,950 to 26,775
	60%	15,300 to 22,950
	40%	11,475 to 15,300
ADB 7000-1T	100%	16,425 to 18,250
	90%	14,600 to 16,425
	80%	12,775 to 14,600
	70%	10,950 to 12,775
	60%	7,300 to 10,950
	40%	5,475 to 7,300

Industrial Processes:

Model	Duty Cycle	Volume (ft³)
ADB 7000-4T	100%	22,050 to 24,500
	90%	19,600 to 22,050
	80%	17,150 to 19,600
	70%	14,700 to 17,150
	60%	9,800 to 14,700
	40%	7,350 to 9,800
ADB 7000-2T	100%	11,070 to 12,300
	90%	9,840 to 11,070
	80%	8,610 to 9,840
	70%	7,380 to 8,610
	60%	4,920 to 7,380
	40%	3,690 to 4,920
ADB 7000-1T	100%	5,310 to 5,900
	90%	4,720 to 5,310
	80%	4,130 to 4,720
	70%	3,540 to 4,130
	60%	2,360 to 3,540
	40%	1,770 to 2,360

Performance capacity is just a guideline. ADB system design is application specific and depends on many factors, including existing bio load of the environment as well as what you are trying to achieve (improved air quality, odor elimination, food safety, increased shelf life of perishables, increased crop yield, etc.). Specific industrial processes (i.e. food processing or food safety, indoor farming) and/or certain air/surface quality issues may require up to 5 times the treatment concentration to achieve desired results. **Please contact your PathogenFocus representative for proper ADB system design.**

ADB System Diagram:

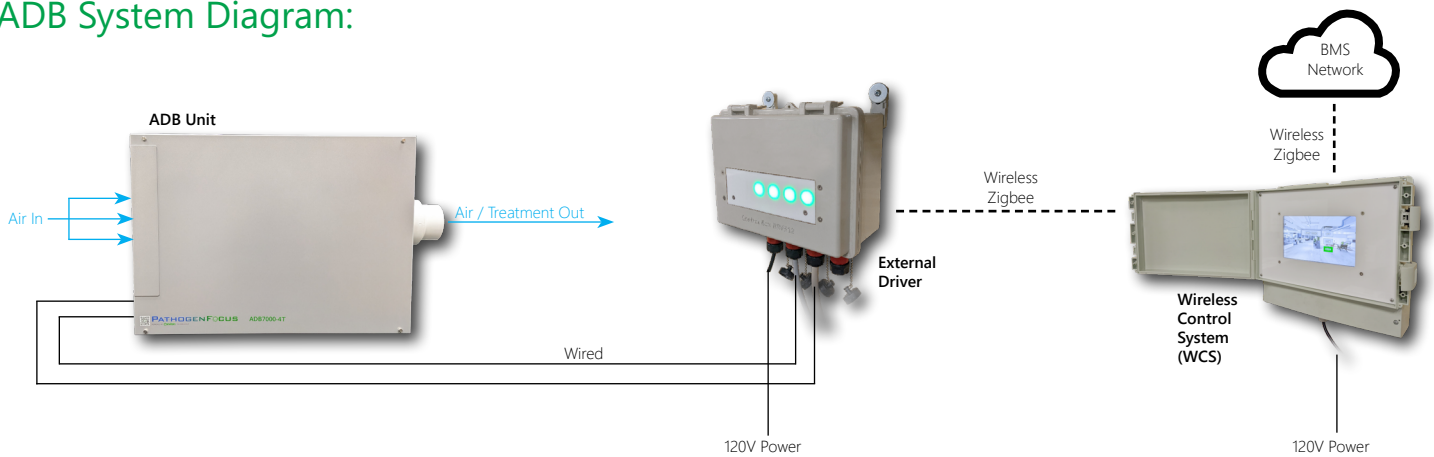

User Guide

No part of this document may be used for any purpose other than the purposes specifically indicated herein nor may it be reproduced or transmitted in any form or by any means, electronic, or mechanical, including photocopying and/or recording for any purpose without permission from the manufacturer.

This information appearing in this document is for general purposes only. The manufacturer makes no warranty of any kind with regard to the information appearing in this document including, but not limited to, implied warranties of merchantability and/or fitness for particular use or purpose. The manufacturer assumes no responsibility for the results, direct and/or indirect, of any misuse of the information appearing in this document nor for any use of the manufacturer product offering referred to herein in any manner deviating from the recommendations made in this document. The manufacturer assumes no responsibility for the use of any parts, components, or other ancillary appliances including circuitry other than as recommended hereunder or other than that embodied in the product.

Guidelines For User Safety And Equipment

Protection symbols are used to highlight information relating to the user’s personal safety and protection of the equipment throughout this guide. Do not operate the equipment without prior consulting with a representative.

When any of the following symbols appear, the associated information must be read carefully and understood fully. Operate the system through its controller.

Warnings



WARNING

The identified danger can cause physical and property damage



DANGER

The identified danger can cause severe physical and property damage. This symbol relates specifically to electrical danger.

Under no circumstances will the manufacturer be liable or responsible for any consequential damage that may arise as a result of the installation or use of this equipment. All examples and diagrams shown in this guide are intended to aid understanding. They do not guarantee operation. The manufacturer accepts no responsibility for the actual use of this equipment based on these examples.

Due to the great variety of possible applications for this equipment, the user must assess the suitability of this product for specific applications.

Equipment described herein is recommended based on the room temperature, type of process, the air circulation of the room, and overall size of the room. The user of this product further acknowledges that in order for the equipment to achieve optimal results, there must be sufficient air circulation, a somewhat enclosed treated area, and when applicable, proper ventilation in the packaging of stored/palletized product(s).

